

2.098	2.000	20	21
1.998	1.900	19	20
1.898	1.800	18	19
1.798	1.700	17	18
1.698	1.600	16	17
1.598	1.500	15	16
1.498	1.400	14	15
1.398	1.300	13	14
1.298	1.200	12	13
1.198	1.100	11	12
1.098	1.000	10	11
.998	.900	9	10
.898	.800	8	9
.798	.700	7	8
.698	.600	6	7
.598	.500	5	6
.498	.400	4	5
.398	.300	3	4
.298	.200	2	3
.198	.100	1	2
C	B	A	NO OF POSN

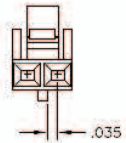

DETAIL FOR 2 POSITION

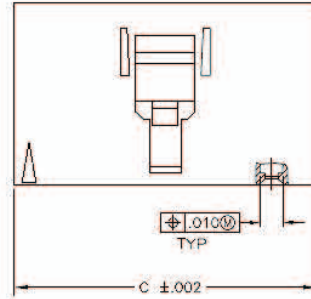
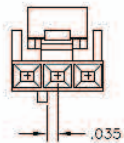

DETAIL FOR 3 POSITION

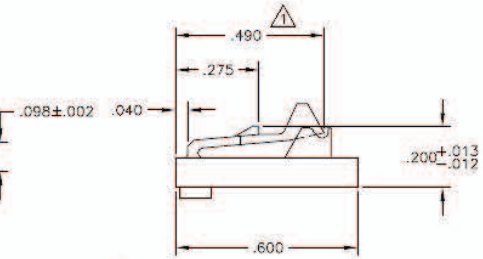
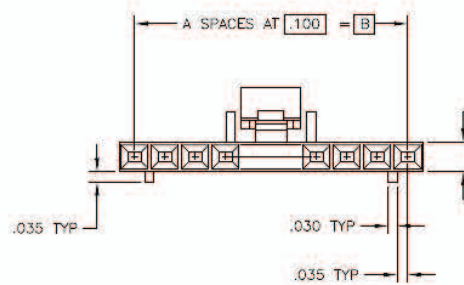

THIS DIMENSION .480 FOR 2 POS ONLY

MATERIAL: FLAME RETARDANT - BLACK THERMOPLASTIC

Information including Drawings, Schematics, Links and Code (Software) Supplied or Referenced in this Document is supplied by MPJA inc. as a service to our customers and accuracy or usefulness is not guaranteed nor is it an Endorsement of any particular part, supplier or manufacturer. Use of information and suitability for any application is at users own discretion and user assumes all risk.

All rights are retained by the respective Owners/Author(s)  
Information is Subject to Change Without Notice

<b>www.mpja.com</b>		
Title 0.1" Pitch Female Connector 11" Lead		
Size	Document Number <b>36605-PL</b>	Rev.
Date	Sheet	